

Approval of Article 4 Direction already Registered

Reg 6/12/93
approval.

WYRE BOROUGH COUNCIL

TOWN AND COUNTRY PLANNING ACT, 1990
TOWN AND COUNTRY PLANNING GENERAL DEVELOPMENT ORDER, 1988

LAND AT HAMILTON HOUSE FARM, GARSTANG ROAD, CHURCHTOWN, DIRECTION

W H E R E A S the Wyre Borough Council being the appropriate local planning authority within the meaning of Article 4 of the Town and Country Planning General Development Order, 1988 is satisfied that it is expedient that development of the description set out in the Schedule hereto should not be carried out on land at Hamilton House Farm, Garstang Road, Churchtown, near Preston, Lancashire being the land shown edged red on the plan annexed hereto unless permission therefor is granted on application made under the Town and Country Planning General Development Order, 1988.

AND WHEREAS the Council considers that development of the said description would be prejudicial to the proper planning of its area and would constitute a threat to the amenities of its area and that the provisions of paragraph (4) of Article 5 of the said General Development Order should apply to this direction.

NOW THEREFORE the said Council in pursuance of the powers conferred upon it by the said Article 4 hereby DIRECTS that the planning permission granted by Article 3 of the Town and Country Planning General Development Order, 1988 shall not apply to development on the said land of the description set out in the Schedule hereto.

THIS DIRECTION is made in pursuance of the provisions of the said Article 4 and of paragraph (4) of the said Article 5 and shall remain in force until 25th November, 1993 (being six months from the date of this Direction) and will then expire unless it has been approved by the Secretary of State for the Environment before that date.

THE SCHEDULE

Part 4 - Temporary Buildings and Uses, Class B

The use of any land for any purpose for not more than 28 days in total in any calendar year, of which not more than 14 days in total may be used for the holding of a market or for motor car and motor cycle racing including trials of speed, and practising for these activities, and the provision on the land of any moveable structure for the purposes of the permitted use.

Given under the Common Seal of
the Wyre Borough Council this 25th
day of May, 1993.

M.R. Oliver
Authorised Officer

5496

The Secretary of State for the Environment
hereby approves the foregoing direction.

M0593SE
JH/KOB

Signed by authority
of the Secretary of
State

R.C. Greenwood
Assistant Secretary
in the Department
of the Environment

23 November 1993

WYRE BOROUGH COUNCIL

TOWN AND COUNTRY PLANNING ACT, 1990
TOWN AND COUNTRY PLANNING GENERAL DEVELOPMENT ORDER, 1988

LAND AT HAMILTON HOUSE FARM, GARSTANG ROAD, CHURCHTOWN, DIRECTION

W H E R E A S the Wyre Borough Council being the appropriate local planning authority within the meaning of Article 4 of the Town and Country Planning General Development Order, 1988 is satisfied that it is expedient that development of the description set out in the Schedule hereto should not be carried out on land at Hamilton House Farm, Garstang Road, Churchtown, near Preston, Lancashire being the land shown edged red on the plan annexed hereto unless permission therefor is granted on application made under the Town and Country Planning General Development Order, 1988.

AND WHEREAS the Council considers that development of the said description would be prejudicial to the proper planning of its area and would constitute a threat to the amenities of its area and that the provisions of paragraph (4) of Article 5 of the said General Development Order should apply to this direction.

NOW THEREFORE the said Council in pursuance of the powers conferred upon it by the said Article 4 hereby DIRECTS that the planning permission granted by Article 3 of the Town and Country Planning General Development Order, 1988 shall not apply to development on the said land of the description set out in the Schedule hereto.

THIS DIRECTION is made in pursuance of the provisions of the said Article 4 and of paragraph (4) of the said Article 5 and shall remain in force until 25th November, 1993 (being six months from the date of this Direction) and will then expire unless it has been approved by the Secretary of State for the Environment before that date.

THE SCHEDULE

Part 4 - Temporary Buildings and Uses, Class B

The use of any land for any purpose for not more than 28 days in total in any calendar year, of which not more than 14 days in total may be used for the holding of a market or for motor car and motor cycle racing including trials of speed, and practising for these activities, and the provision on the land of any moveable structure for the purposes of the permitted use.

Given under the Common Seal of
the Wyre Borough Council this 25th
day of May, 1993.

M. R. Oliver
Authorised Officer

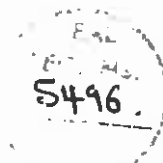

M0593SE4JH
JH/KOB

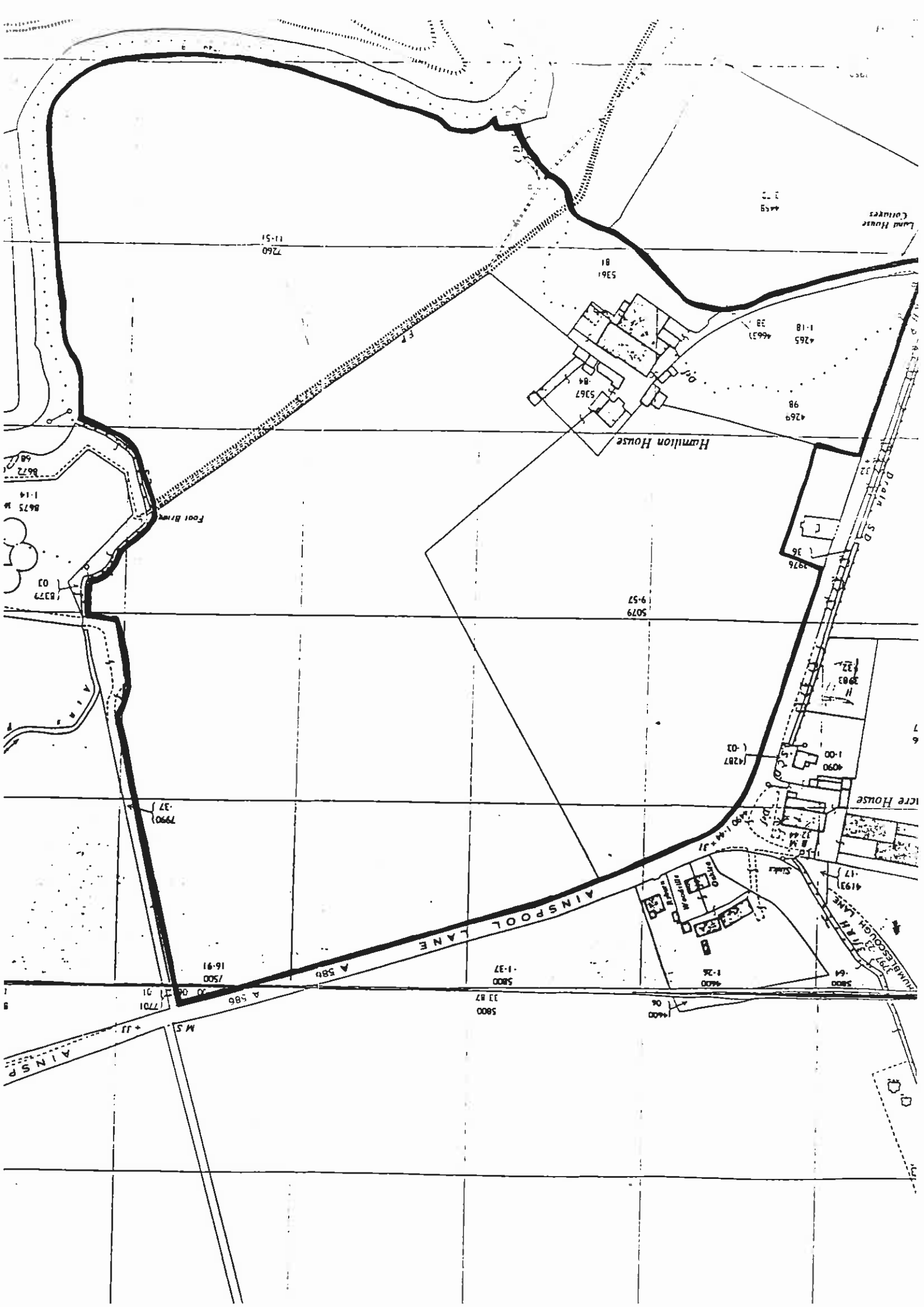

Land Houses

Hamilton House

Ice House

AINSPOOL LANE

AINSPOOL

4459

5361

4265

1-18

4663

38

98

4269

5367

84

1876

36

5079

9-57

4090

1-00

4287

03

4193

17

5800

64

1-26

4400

06

5800

33

87

5800

1-37

5800

16-91

586

7701

01

7701

01

7701

01

7701

01

7701

01

7701

01

7701

01

7701

01

7701

01

7701

01

7701

01

8672

1-14

8675

03

18379

03

18379

03

18379

03

18379

03

18379

03

18379

03

18379

03

18379

03

18379

03

18379

03

18379

03

18379

03

18379

03

18379

03

18379

03

18379

03

18379

03

18379

03

18379

03

18379

03

8672

1-14

8675

03

18379

03

18379

03

18379

03

18379

03

18379

03

18379

03

18379

03

18379

03

18379

03

18379

03

18379

03

18379

03

18379

03

18379

03

18379

03

18379

03

18379

03

18379

03

18379

03

18379

03

18379

03

18379

03

18379

03

18379

03

18379

03

18379

03

18379

03

18379

03

18379

03

18379

03

18379

03

8672

1-14

8675

03

18379

03

18379

03

18379

03

18379

03

18379

03

18379

03

18379

03

18379

03

18379

03

18379

03

18379

03

18379

03

18379

03

18379

03

18379

03

18379

03

18379

03

18379

03

18379

03

18379

03

18379

03

18379

03

18379

03

18379

03

18379

03

18379

03

18379

03

18379

03

18379

03

18379

03

18379

03

8672

1-14

8675

03

18379

03

18379

03

18379

03

18379

03

18379

03

18379

03

18379

03

18379

03

18379

03

18379

03

18379

03

18379

03

18379

03

18379

03

18379

03

18379

03

18379

03

18379

03

18379

03

18379

03

18379

03

18379

03

18379

03

18379

03

18379

03

18379

03

18379

03

18379

03

18379

03

18379

03

18379

03

8672

1-14

8675

03

18379

03

18379

03

18379

03

18379

03

18379

03

18379

03

18379

03

18379

03

18379

03

18379

03

18379

03

18379

03

18379

03

18379

03

18379

03

18379

03

18379

03

18379

03

18379